

Wiring diagram
POWER SUPPLY ELECTRIC VEHICLE

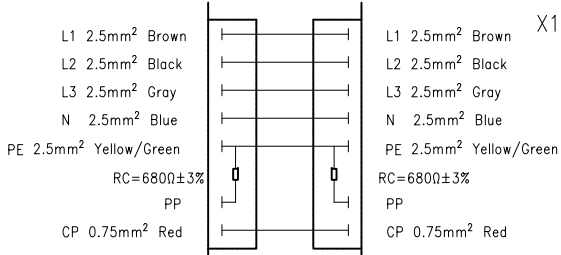

X1
Laser Printing Front Note:

Laser Printing Back Note(Arial):
 MEAC-T-016A-P1-03-5.0M-30AH
 16A 480V AC
 IEC 62196-2:2016
 IP54
 20xxxxxx-xxxx

X2
Laser Printing Front Note(Arial):
 MEAC-T-016A-V1-03-5.0M-30AH
 16A 480V AC
 IEC 62196-2:2016
 IP54
 20xxxxxx-xxxx
Laser Printing Back Note:

未注公差/General tolerances(mm)										D 0.1/10
0	>3	>6	>10	>18	>30	>50	>80	>120	>180	
~	~	~	~	~	~	~	~	~	~	~
±0.12	±0.18	±0.22	±0.26	±0.31	±0.37	±0.57	±0.80	±0.93	±1.05	±1.15
									±1.60	±2.20
										±2.50

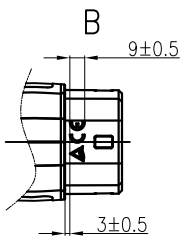
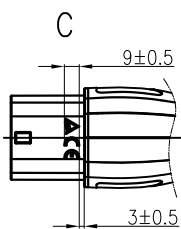
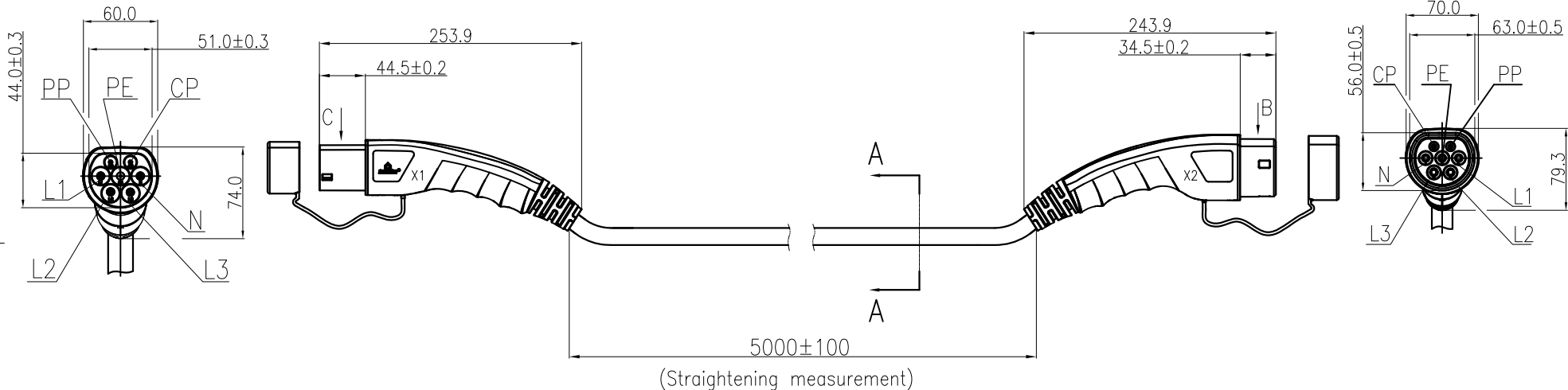
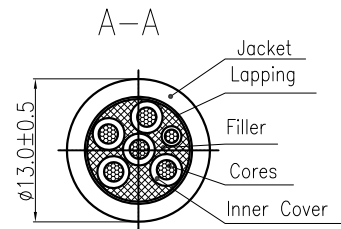

额定电压电流/Rated Voltage/Current	480V AC/16A
绝缘电阻/Insulate Resistance	>100MΩ,500V DC 1min
耐压/Withstanding Voltage	L、N and PE ,2500V AC 1min L and N ,2500V AC 1min
防护等级/Ingress Protection	IP54
插拔寿命/Insertion/Pullout Times	10,000 Times
插拔力/Insertion/Pullout Force	<100N
使用温度范围/Operating temperature(°C)	-30~+50
线材规格/Cable specification	5*2.5mm ² +1*0.75mm ² Black
标准/Reference standard	IEC 62196-2:2016
符合RoHS环保要求/Conform to RoHS	Yes

		MATERIAL:	SURFACE/COLOR:		
MAT NO/REV: DO-1		MAT STATUS:			
NAME MEAC-T-016A-V1P1-03-5.0M-30A(H)					
APPD: Ye DB 2024.07.19	CHKD: Dong RT 2024.07.19	DRFT: Hu MY 2024.07.19	DRAWING NO.	TYPE	DRAWING STATUS
A4			CUSTOMER DRAWING	SCALE 1:3	SHEET 1/1

REV	ECN	DESCRIPTION	DRFT	DATE

Transfer or duplication of this document as well as the utilization or common application of its contents are prohibited unless authorized in advance. All rights reserved for patent, copyright, trademark, or other intellectual property rights. 复制或再行使用本文件内容，除非事先得到许可，否则，公司将保留所有权利。